

Model BPS-S 20°/GHz DC-18GHz 50 Watts

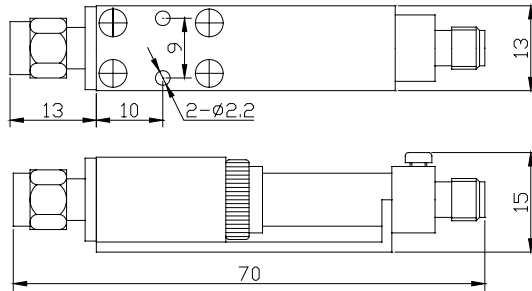

Phase shifters are used to continuously transform the delay of signal and adjust phase of measure system in RF transmission system and mainly used in phase-controlled antenna array radar.

BPS-S phase shifters' average power 50W, frequency range DC-18GHz, adjustable phase 20°per GHz and totally 360° phase adjustable.

MECHANICAL SPECIFICATIONS

Connectors	Male Pin	Female Pin	Housing	Temp Range	Dimensions	Weight
Brass Gold Plated	Brass Gold Plated	Beryllium Copper Gold Plated	Brass Gold Plated	Operating: -10°C~+50°C Non-operating: -40°C~+70°C	70×13×15mm	50g

RoHS Compliant: Yes

ELECTRICAL SPECIFICATIONS

Model Number	Frequency Range(GHz)	Max VSWR	Insertion Loss(dB)	Phase Adjustment
BPS-S-2-40	DC-2	1.25	≤0.35	0-40°
BPS-S-3-60	DC-3	1.30	≤0.5	0-60°
BPS-S-6-120	DC-6	1.40	≤0.75	0-120°
BPS-S-9-180	DC-9	1.50	≤1.0	0-180°
BPS-S-12-240	DC-12	1.60	≤1.25	0-240°
BPS-S-18-360	DC-18	1.60	≤1.5	0-360°

NOMINAL IMPEDANCE: 50Ω

AVERAGE POWER: 50W

PEAK POWER: 5KW (5μs pulse width with 1% duty cycle)

CONNECTOR TYPE: SMA (M, F)

Notes:

1. Dimensions Tolerance ±2%